



B O S
LIGHTING

AMADEUS H300



MAKE LIFE BRIGHTER



CONTACT

Address

BOS Lighting
Dommelseweg 148
5554 NV Valkenswaard
The Netherlands



Online

Emergency email
Email
Website

sos@bos-lighting.nl
info@bos-lighting.nl
www.bos-lighting.nl



SECTION 1
SAFETY INSTRUCTIONS & MAINTENANCE

TABLE OF CONTENTS

SAFETY INSTRUCTIONS & MAINTENANCE	PAGE 3
<i>WHAT IS IN THE BOX?</i>	PAGE 4
<i>DIMENSIONS AMADEUS H300</i>	PAGE 4
INSTALLATION	PAGE 4
<i>PREPARING</i>	PAGE 5
<i>INSTALLATION OF THE CLAMP</i>	PAGE 5
DMX-512 CONTROL CONNECTIONS	PAGE 6
PHOTOMETRIC DATA	PAGE 7
MENU OVERVIEW	PAGE 8
DMX CHANNELS	PAGE 9
<i>20 CH</i>	PAGE 9
DMX VALUE	PAGE 10
ROTATING GOBO	PAGE 11
STATIC GOBO	PAGE 12
TROUBLESHOOTING AND CLEANING	PAGE 13
TECHNICAL SPECIFICATIONS	PAGE 14

This product is for professional use only. It is not for household use.

This product presents risks of severe injury or death due to fire and burn hazards, electric shock and falls. Read this manual before installing, powering or servicing the fixture, follow the safety precautions listed below and observe all warnings in this manual and printed on the fixture. This device has left the factory in perfect condition. In order to maintain this condition and to ensure a safe operation, it is absolutely necessary for the user to follow the safety instructions and warning notes written in this user manual.

If you have questions about how to operate the fixture safely, please contact us via info@bos-lighting.nl.



WARNING!

Read the safety precautions in this section before unpacking, installing, powering or operating this product.

- Review the following safety precautions carefully before installing or operating the fixture. This fixture must be installed in accordance with the applicable installation code by a person familiar with the construction and operation of the fixture and the hazards involved.



WARNING!

Risk of electric shock.

- Always power off/unplug the fixture before removing any covers.
- Ensure that the power is turned off when connecting the fixture to the AC mains supply.
- Do not apply power if the fixture is in any way damaged.
- Do not immerse the fixture in water or liquid.



WARNING!

Take measures to prevent burns and fire.

- Install in a location that prevents accidental contact with the fixture.
- Install only in a well-ventilated space.
- Install at least 0.3 m (12 in.) away from objects to be illuminated.
- Install only in accordance with applicable building codes.
- Ensure a minimum clearance of 0.1 m (4 in.) around the cooling fans.
- Do not paint, cover or modify the fixture.
- Keep all flammable materials away from the fixture.
- Allow the fixture to cool for 15 minutes after operation, before touching it.
- CAUTION: Exterior surface temperature after 5 min. operation = 45 °C



WARNING!

Take measure to prevent personal injury.

- Do not look directly at the light source from close range.
- Take precautions to prevent injury due to falls when working at height.
- For permanent installation, ensure that the fixture is securely fastened to a load-bearing surface with suitable corrosion-resistant hardware.
- For temporary installation with clamps, ensure that the quarter-turn fasteners are turned fully and secured with a suitable safety cable.
- The cable must be approved for a safe working load (SWL) of 10 times the weight of the fixture, and it must have a minimum gauge of 3 mm.



CAUTION!

Disconnect from mains before starting maintenance operation

The following points have to be considered during the inspection:

1. All screws for installing the devices or parts of the device have to be tightly connected and must not be corroded.
2. There must not be any deformations on the housing, color lenses, fixations and installation spots (ceiling, suspension, trussing).
3. Mechanically moved parts must not show any traces of wearing and must not rotate with unbalances.
4. The electric power supply cables must not show any damage, material fatigue or sediments.

Further instructions depending on the installation spot and usage have to be adhered by a skilled installer and any safety problems have to be removed.

SECTION 2 INSTALLATION

WHAT IS IN THE BOX?

- 1x AMADEUS H300
- 1x Shuko -> True1
- 2x Brackets with quicklock
- 1x Safety cable

DIMENSIONS AMADEUS H300

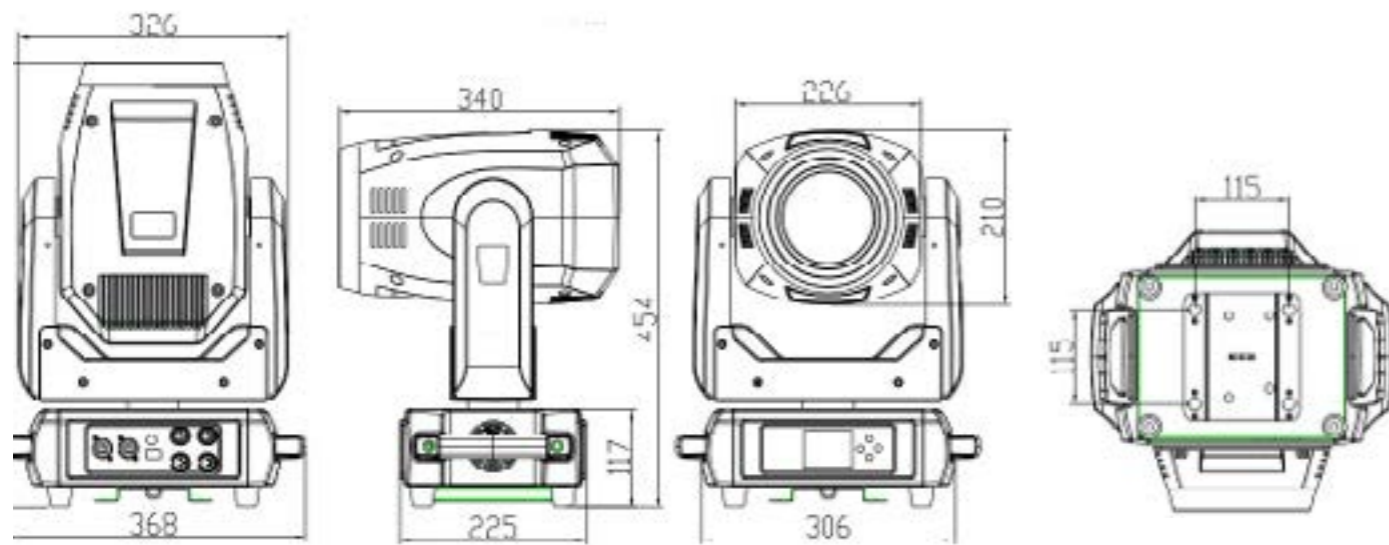

PREPARING

Unpack the fixture and inspect it to ensure that it has not been damaged during transport. Read the manual before installation.

When selecting a location for the fixture, ensure that:

- It is situated away from public thoroughfares and protected from contact with people.
- It is placed with no chance of getting wet
- It has adequate ventilation.

INSTALLATION OF THE CLAMP

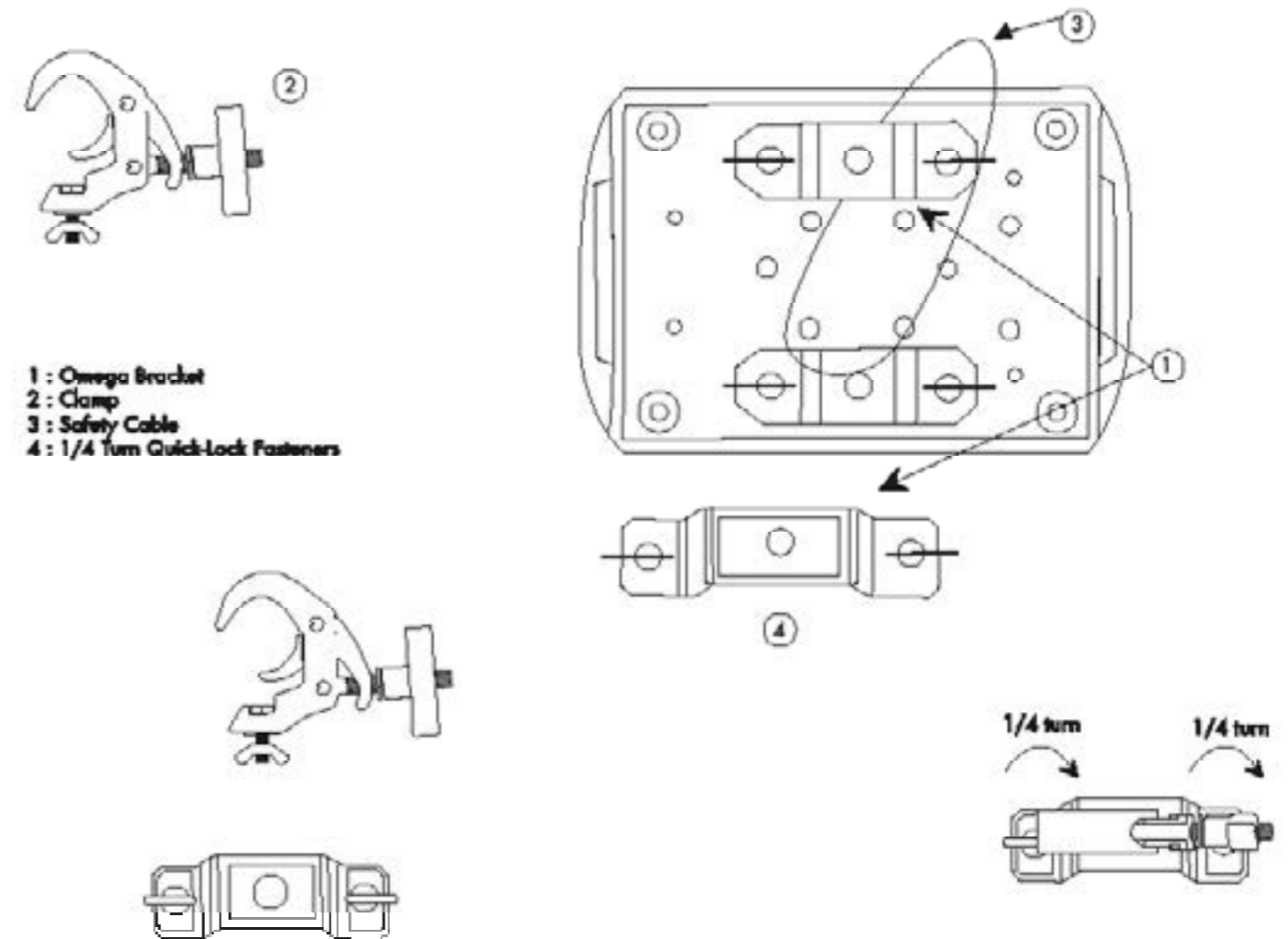



SECTION 3 DMX-512 CONTROL CONNECTIONS

SECTION 4 PHOTOMETRIC DATA

Connect the provided XLR cable to the female 3-pin XLR & 5-pin XLR output of your controller and the other side to the male 3-pin XLR & 5-pin XLR input of the moving head. You can chain multiple moving head together through serial linking. The cable needed should be two core, screened cable with XLR input and output connectors. Please refer to the diagram below.

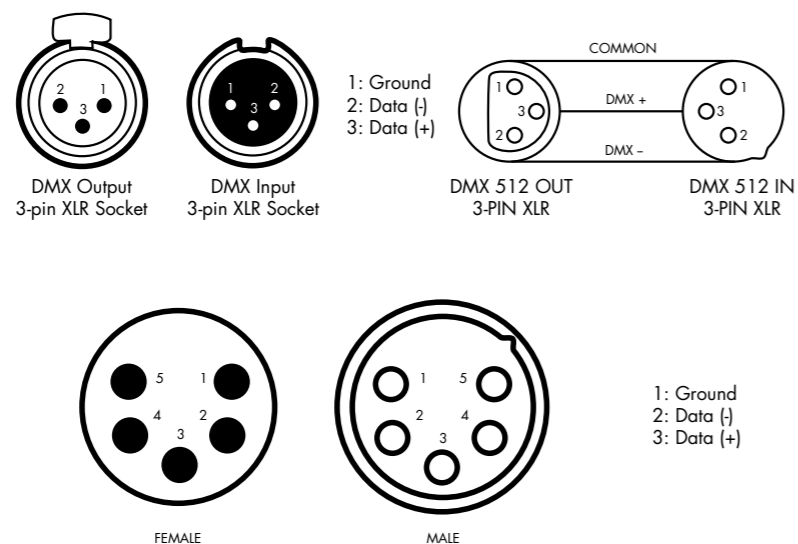

For installations where the DMX cable has to run a long distance or is in an electrically noisy environment, it is recommended to use a DMX terminator. This helps in preventing corruption of the digital control signal by electrical noise. The DMX terminator is simply an XLR plug with a 120 Ω resistor connected between pins 2 and 3, which is then plugged into the output XLR socket of the last fixture in the chain.

Please see illustrations below.

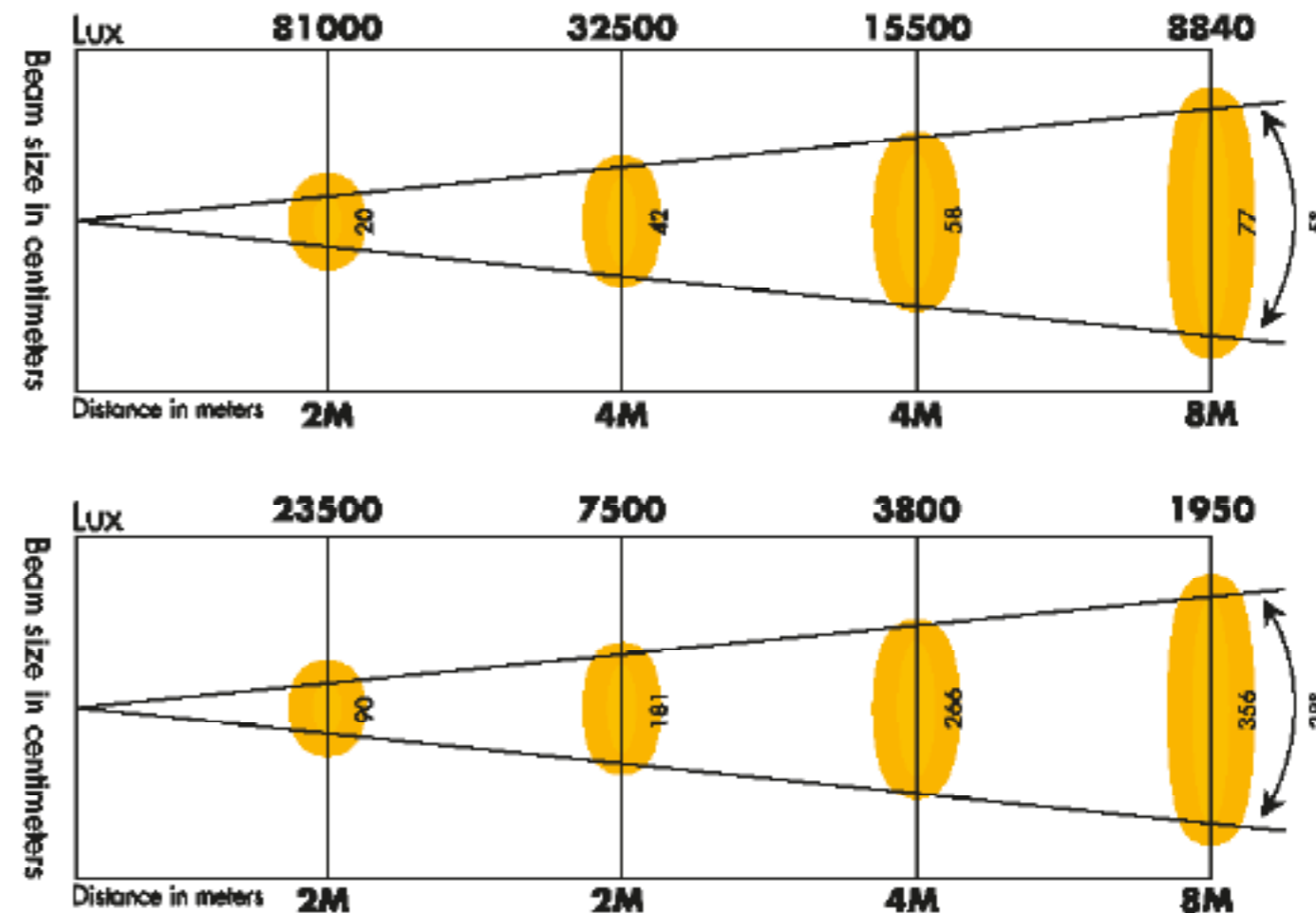
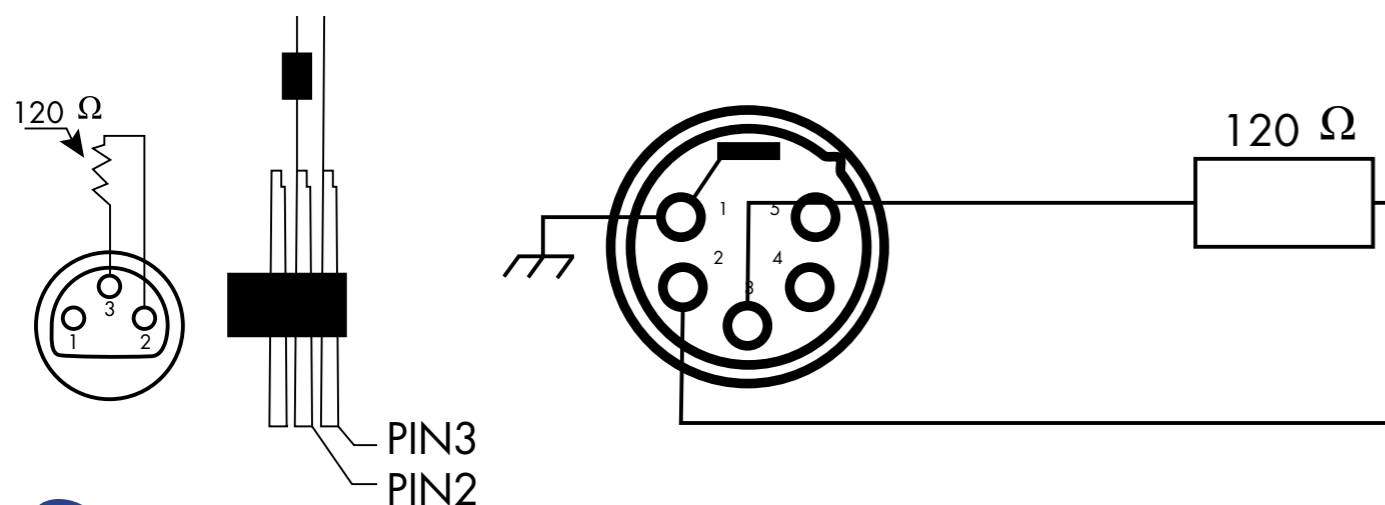



SECTION 5 MENU OVERVIEW

SECTION 6 DMX CHANNELS

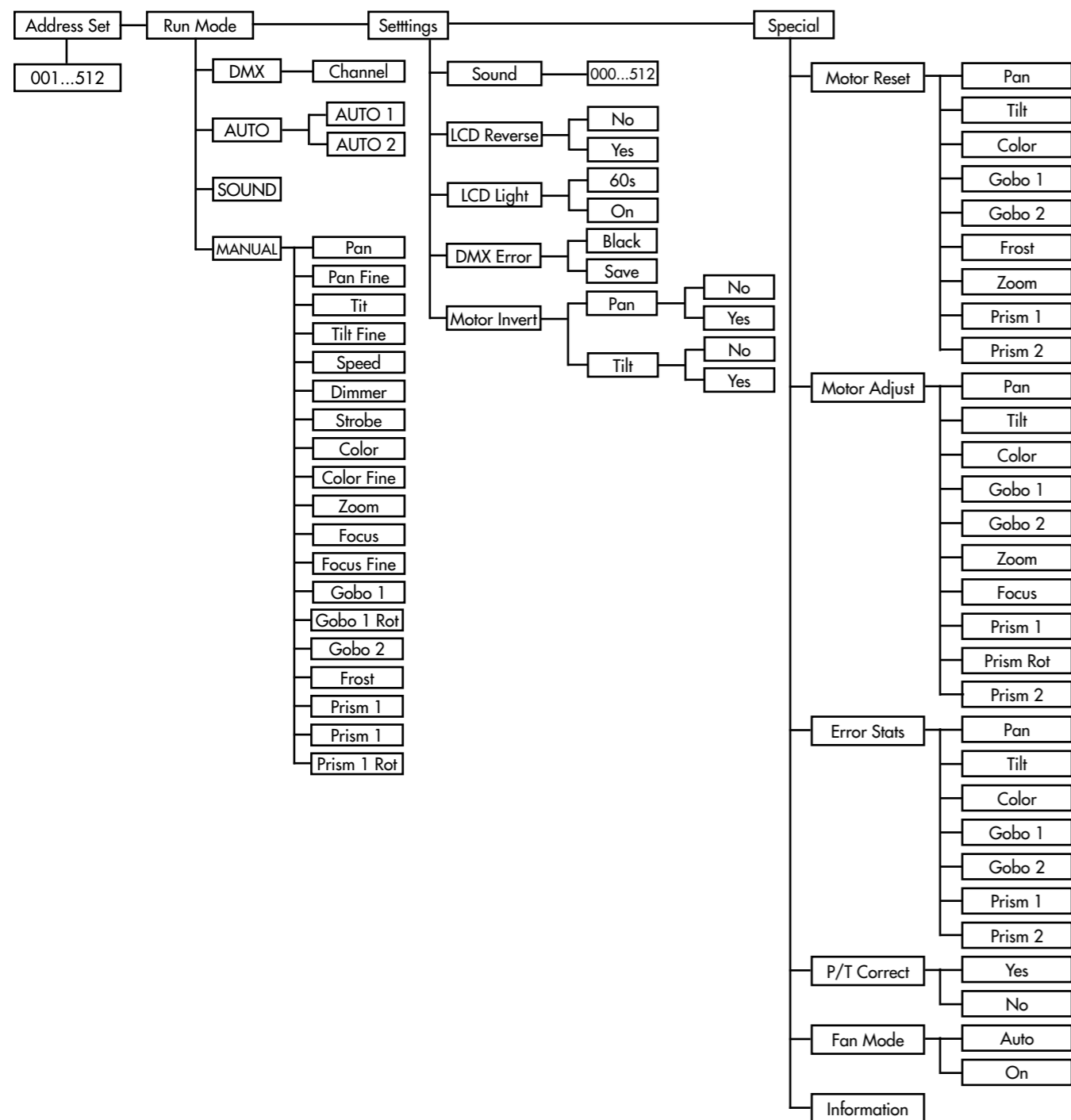

20 CH

Channel	Function	Value	Description
1	Pan	000...255	0-540°
2	Pan Fine	000...255	Fine
3	Tilt	000...255	0-270°
4	Tilt Fine	000...255	Fine
5	X, Y Speed	000...255	Fast to slow
6	Dimmer	000...255	Dark to bright
7	Shutter	000...255	See DMX value Page 11
8	Color	000...255	See DMX value Page 11
9	Colorwheel Pos	000...255	Split color
10	Zoom	000...255	Wide to narrow
11	Focus	000...255	Far to near
12	Focus Fine	000...255	Far to near
13	Rotating Gobo	000...255	See DMX value Page 11
14	Gobo Rotate	000...255	See DMX value Page 11
15	Static Gobo	000...255	See DMX value Page 11
16	Frost	064...255	Frost in
17	Prism	000...063	No Prism
		064...127	Linear
		128...191	Prism 3 way
		192...255	Dubble prism
18	Prism Index	000...255	0 to 360
19	Prism Rotate	000...255	See DMX value Page 11
20	Control	000...019	No Function
		020...039	Auto 1
		040...059	Auto 2
		060...199	No Function
		200...219	Reset All
		220...255	No Function



SECTION 7 DMX VALUE

Function	Value	Description
Shutter	000...004	On
	005...099	Strobe from slow to fast
	100...199	Pulse from slow to fast
	200...239	RND from slow to fast
	240...255	On
Color	000...019	White
	020...039	Red
	040...059	Yellow
	060...079	Blue
	080...099	Cyan
	100...119	Magenta
	120...139	Green
	140...159	Orange
	160...179	UV
	180...217	CW from Fast to Slow
	218...225	CCW from Slow to Fast
	Prism Rotating	000...063
064...123		Rotating CW fast to slow
124...135		Stop
136...195		Rotating CCW slow to fast
196...255		CW - CCW shake
Gobo Rotation	000...019	Gobo Still
	020...102	Gobo self-rotating CW from Fast to Slow
	103...108	Stop
	109...191	Gobo self-rotating CCW rotating from slow to fast
	192...255	CW - CCW shake

Function	Value	Description
Rotating Gobo	000...011	Open
	012...023	Gobo 1
	024...034	Gobo 2
	035...048	Gobo 3
	049...059	Gobo 4
	060...071	Gobo 5
	072...083	Gobo 6
	084...095	Gobo 7
	096...111	Gobo 1 shake
	112...127	Gobo 2 shake
	128...143	Gobo 3 shake
	144...159	Gobo 4 shake
	160...175	Gobo 5 shake
	176...191	Gobo 6 shake
	192...207	Gobo 7 shake
	208...231	Gobo CW Scroll Fast to Slow
	232...255	Gobo CCW Scroll Slow to Fast
Gobo	000...007	Open
	008...015	Gobo1
	016...023	Gobo2
	024...031	Gobo3
	032...039	Gobo4
	040...047	Gobo5
	048...055	Gobo6
	056...063	Gobo7
	064...071	Gobo8
	072...079	Gobo9
	080...094	Gobo1 Shake
	095...109	Gobo2 Shake
	110...124	Gobo3 Shake
	125...139	Gobo4 Shake
	140...154	Gobo5 Shake
	155...169	Gobo6 Shake
	170...184	Gobo7 Shake
	185...199	Gobo8 Shake
	200...214	Gobo9 Shake
	215...234	Gobo CW Scroll Fast to Slow
	235...255	Gobo CCW Scroll Slow to Fast

SECTION 8 ROTATING GOBO





SECTION 8 STATIC GOBO

SECTION 9 TROUBLESHOOTING AND CLEANING

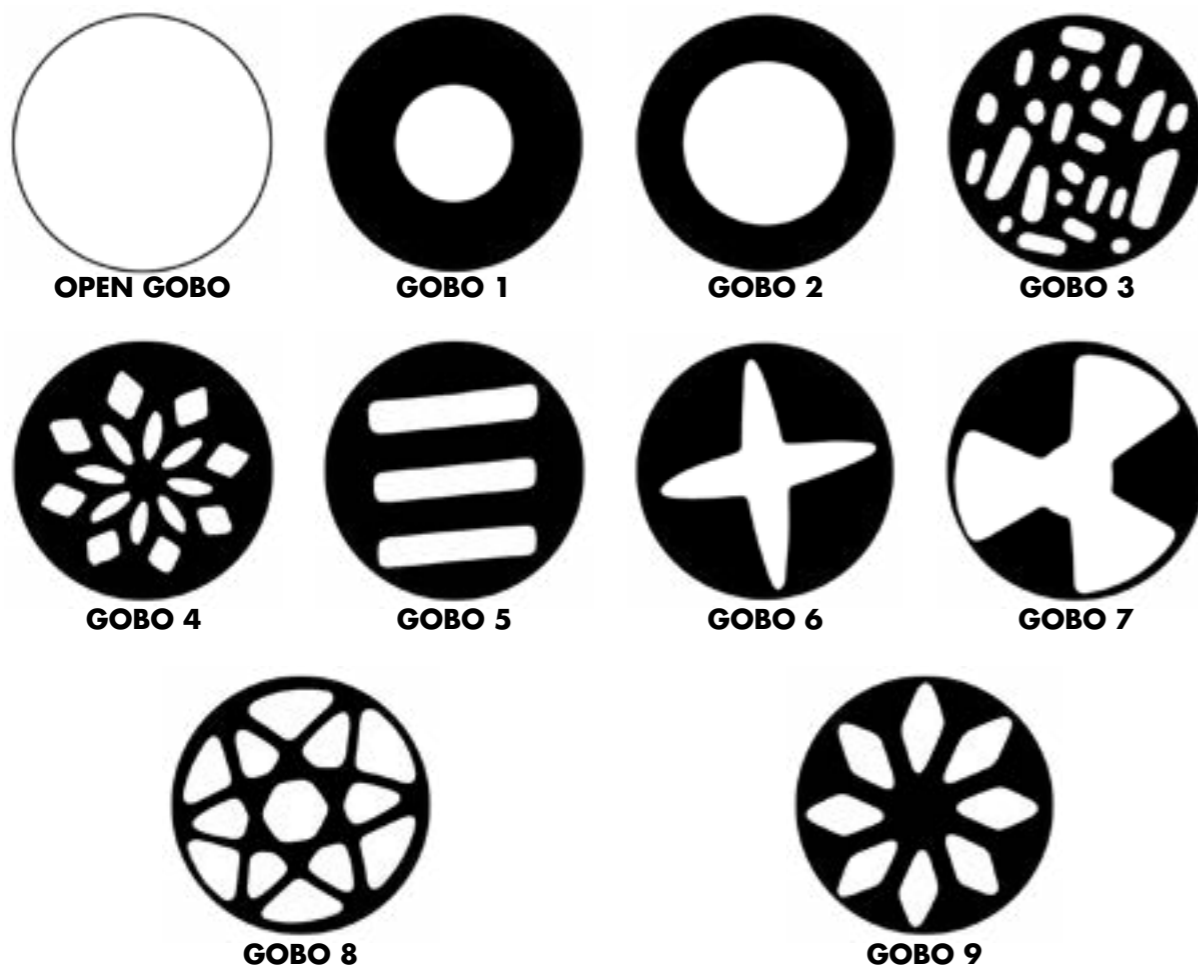

CAUTION!

Disconnect from mains before starting maintenance operation

The lamp contains professional components such as microcomputer circuit board and high-voltage power supply. For your safety and product life, non-professionals should not disassemble the lamp and related accessories without authorization.

The diode does not light up (except LED light source)

Possible cause: The bulb is not completely cooled, or the bulb has reached the end of its life, the treatment is as follows:

- Due to abnormal operation, the bulb is not completely cooled down, so let the lamp body cool down for more than 10 minutes to make the inside completely return to normal state, and then turn on the power again.
- Check whether the bulb has reached the end of its life, and replace it with a new one.
- Check whether the bulb and the lighter circuit are leaking, falling off, or having poor contact.
- Replace with a new light source.

The light beam appears dim

Possible cause: The bulb has been used for a long time or the light path is not clean, the treatment is as follows:

- Check whether the bulb has reached the end of its life, and replace it with a new one
- Check whether the optical components or bulbs are clean, and whether there is dust on the bulbs and other optical components.
- Regular cleaning and maintenance of the bulbs and components in the lamps are required.

Blurred pattern projection

Possible cause: Lenses are dirty or electronic focus is defect:

- Check if lenses are clean.
- Check whether the electronic focus channel value is suitable for the current projection distance.

The lamps work intermittently

Possible cause: The internal circuit enters the protection state, and the treatment is as follows

- Check whether the fan is operating normally or whether it is dirty, causing the internal temperature of the lamp to rise
- Check whether the internal temperature control switch is closed
- Check whether the bulb has reached the end of its service life, and replace it with a new one.

After the lamp is reset normally, it does not accept the control of the console

Possible cause: signal line failure or abnormal lamp parameter setting, the treatment is as follows:

- Check the start address code and check the connection of the DMX signal line (whether the signal line cable is intact, and whether the connection of the head is loose)
- Add signal amplifier, add 120 ohm terminal resistance.

The lamp can't start

Possible cause: bad power line, the treatment is as follows:

- Check whether the fuse on the power input socket is fused, replace the fuse.
- Lamps have poor line contact due to vibration during long-distance transportation.
- Check the input power, computer board and other plug-in devices.



CAUTION!

Disconnect from mains before starting cleaning operation

In order to make the lights in good condition and extend the life time, we suggest a regular cleaning to the lights.

1. Clean the inside and outside lens each week to avoid the weakness of the lights due to accumulation of dust.
2. Clean the fan each week.
3. A detailed electric check by approved electrical engineer each three month, make sure that the circuit contacts are in good condition, prevent the poor contact of circuit from overheating.

We recommend a frequent cleaning of the device. Please use a moist, lint-free cloth. Never use alcohol solvents.

There are no serviceable parts inside the device. Please refer to the instructions under "Installation instructions". Should you need any spare parts, please order genuine parts from your local dealer.

SECTION 10

TECHNICAL SPECIFICATIONS

Light Source	350W	
Optical properties	Beam angle	5.5°~ 32°
	Repetition rate	3000 Hz
Control	DMX	
	Master-slave and sound activated controllable or auto operation	
Number of DMX channels	20CH	
Power connections	Lockable True1 In/Out	
Control connections	DMX control	3-pin XLR In/Out
Power consumption	350 W	
Operating supply voltage	100 – 240 V 50/60 Hz	
Protection class	IP20	
Mounting options	Hanging with Two 1/4 turn fastening Omega Clamps or standing	
Dimensions (W × H × D), with bracket	328 mm (W) - 520 mm (H) - 216 mm (D)	
Weight	15.2 kg	
Ambient conditions	Temperature range	-20 °C...40 °C
Construction	Movinghead	
Number of LEDs	1	
Color mixture	8 colors + white light	
LED type	350W High Output White LED	
Floor housing	Yes	
Fan	Internal Fans	
Wireless DMX	No	
Housing color	Black	
Temperature protect function	Electronic temperature control overheating protection, electronic temperature control automatic power-off protection when the overheating system fails	
Gobo Rotating	7 Rotating Gobos	
Gobo Static	9 fixed Gobos + Open	
Prism	2 prism, prism can rotate forward and reverse	
LCD	LCD display, key + touch dual operation mode	